



Special Application for shower



KB/4025



BRISA-160 in shower

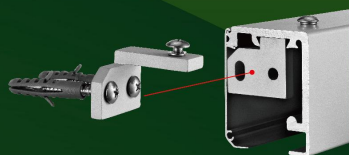
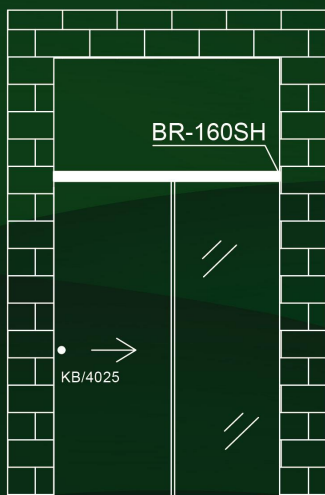

BR-160SH
Side holder bracket

Top view (open)



Top view (close)



Agent/ Distributor



GOOD CREDIT CORPORATION

No.13, Longmen Rd., Situn Dist., Taichung 40757, Taiwan

E-mail: gcctw@ms7.hinet.net

TEL: 886-4-22583755 (Hunting Line)

FAX: 886-4-22583753

<http://www.gccintw.com.tw>



BRISA-160 ultra slim

soft stop sliding door system

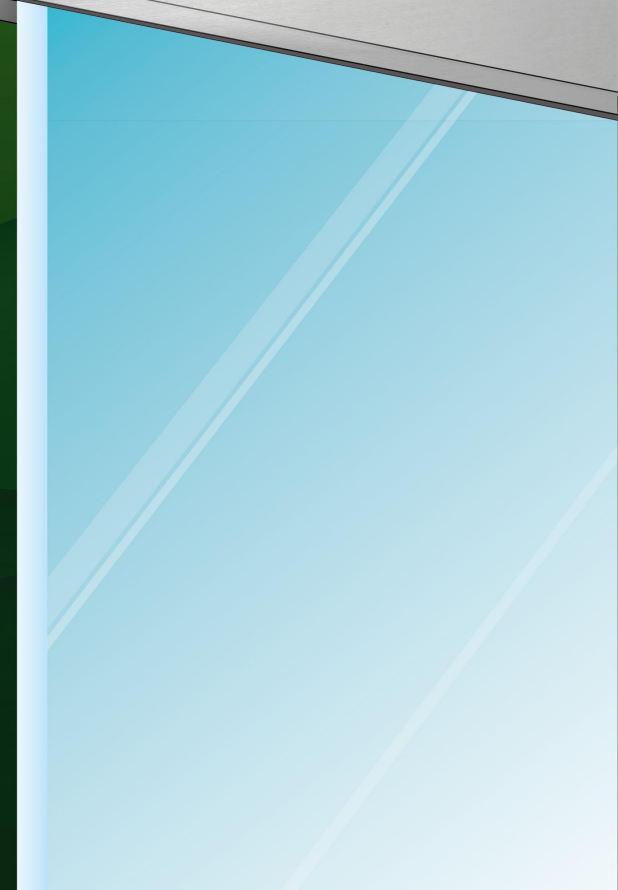
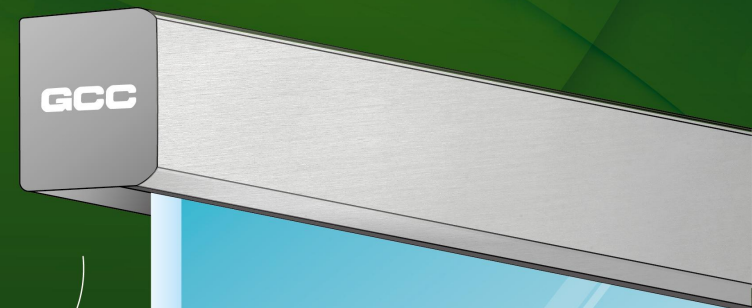

The first idea to design BRISA-160 system was to give the users totally different experience when they are operating the system.

With GCC innovative design, allowing for a smooth and effortless operation, and the installer also can easily install the system in a short time.

Technical data

- Max. loading capacity: 60 kg
- For glass thickness **10mm (standard)**
8mm (by order)
- Ultra slim profile with only 50mm x 60mm
- Suitable for wall mount or ceiling fixing
- Easy height adjustment 4mm
- Track and cover are available in MS finish(**mat silver**)

Features

- Minimum glass width with both ends soft stop function : 740mm
- No glass drilling required
- Easy height adjustment 4mm
- Adjustable bottom guide from glass thickness 8mm ~ 12mm

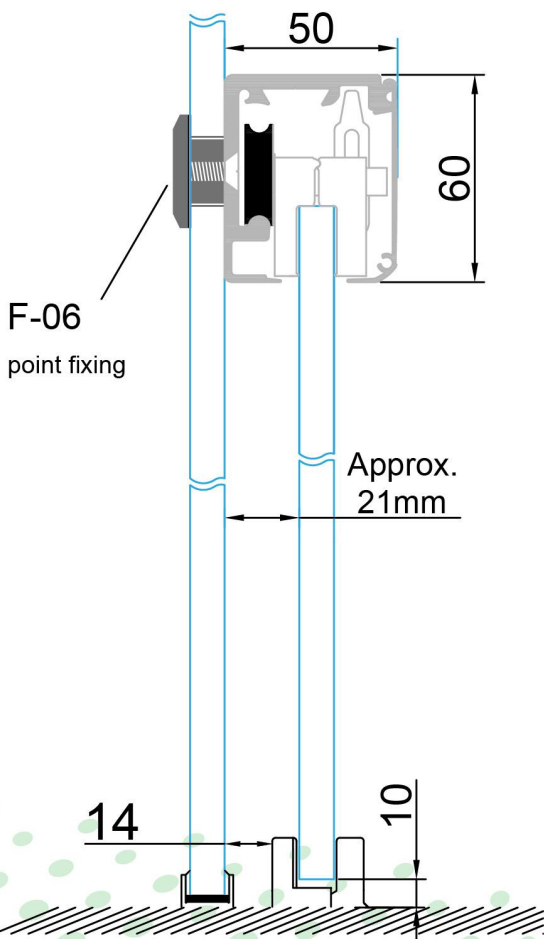

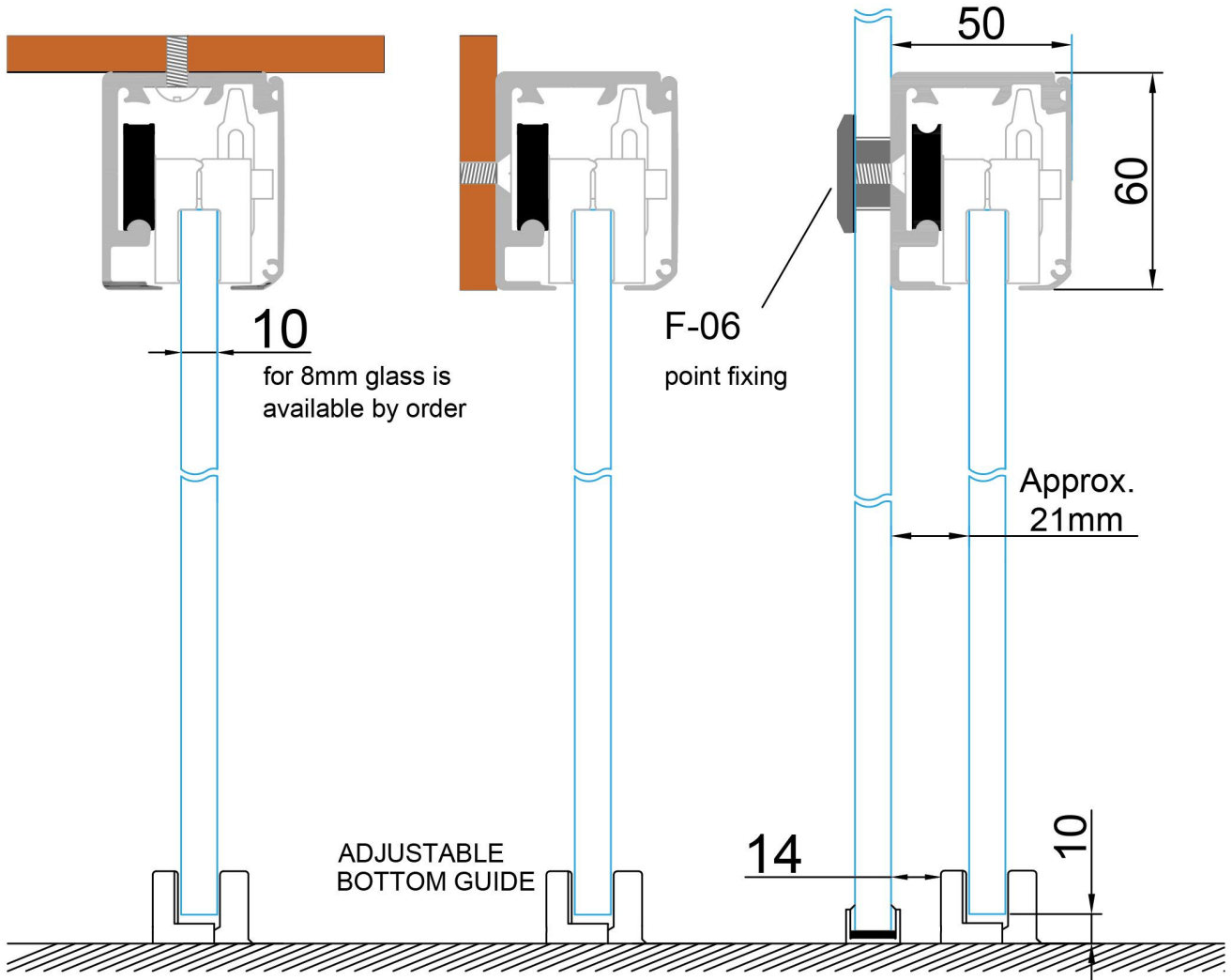

optional by order



CFH-65S
Concealed Handle



KB/4025
Door Knob

To seal the gap

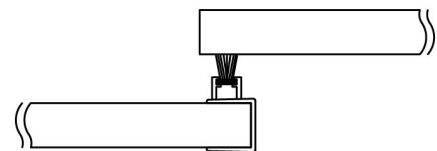

PF-10 "F" Jamb

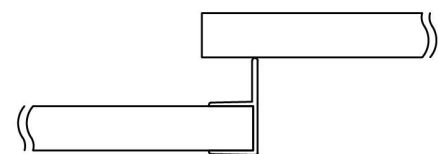

P810 SDJ Side Jamb



The package includes the items below with the top track and the cover



Clamps and the rollers

For glass thickness 10mm use
8mm is by order

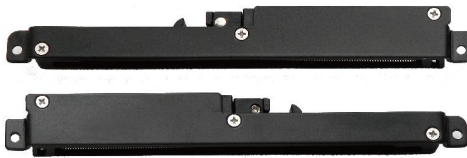

Soft stop devices (L + R)



Active devices and end stoppers



End caps (L + R)

standard finish : black color
Gray color by order



BG-812 Adjustable bottom guide

Standard finish : black color
Gray color by order
(this item can be ordered separately)

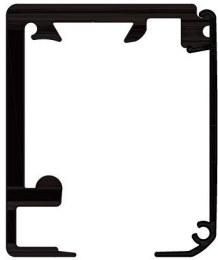

● Top track and the cover are in 2400mm stock lengths with mat silver finish.

Extra accessories by order

● **F-06 point fitting**

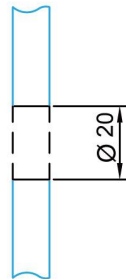

Flat hole

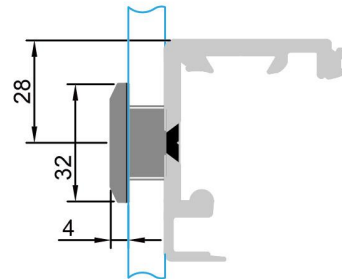

Designed for fixing the fixed panel to the main track for a flat hole

● **C-06 point fitting**

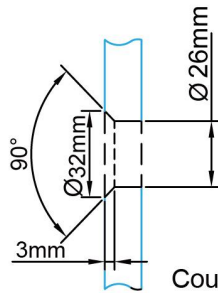

Countersunk hole

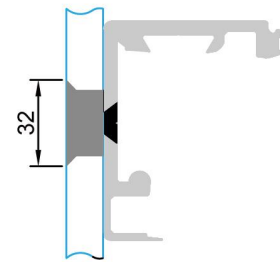

Designed for fixing the fixed panel to the main track for a countersunk hole



GL-34S



GL-34R



9139



9125



9125ST



9137S

For more details please refer to GCC tempered glass fitting catalogue.

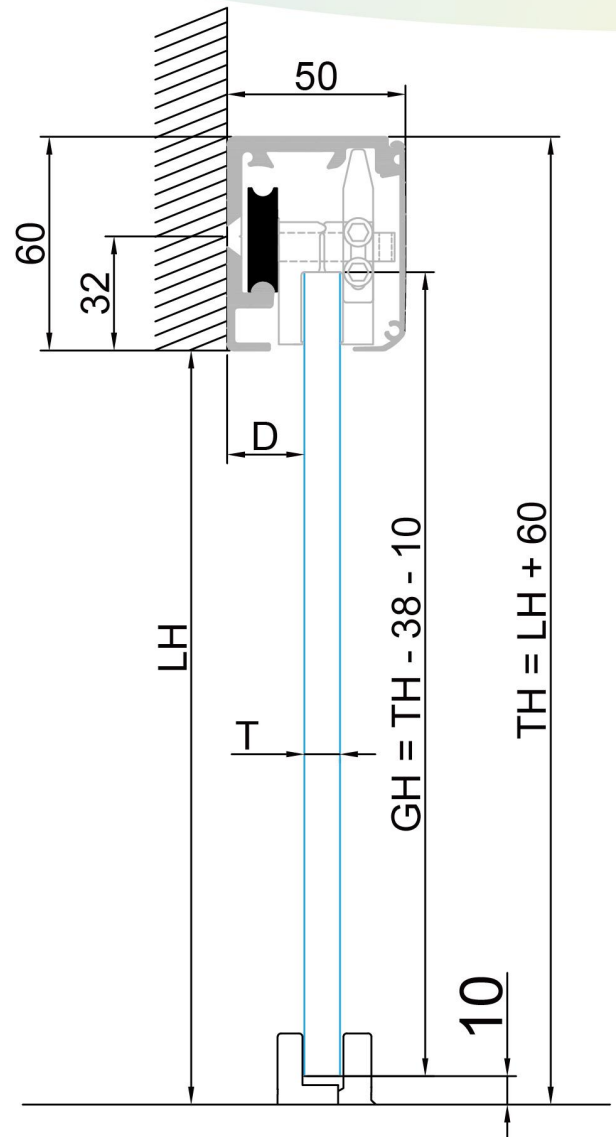
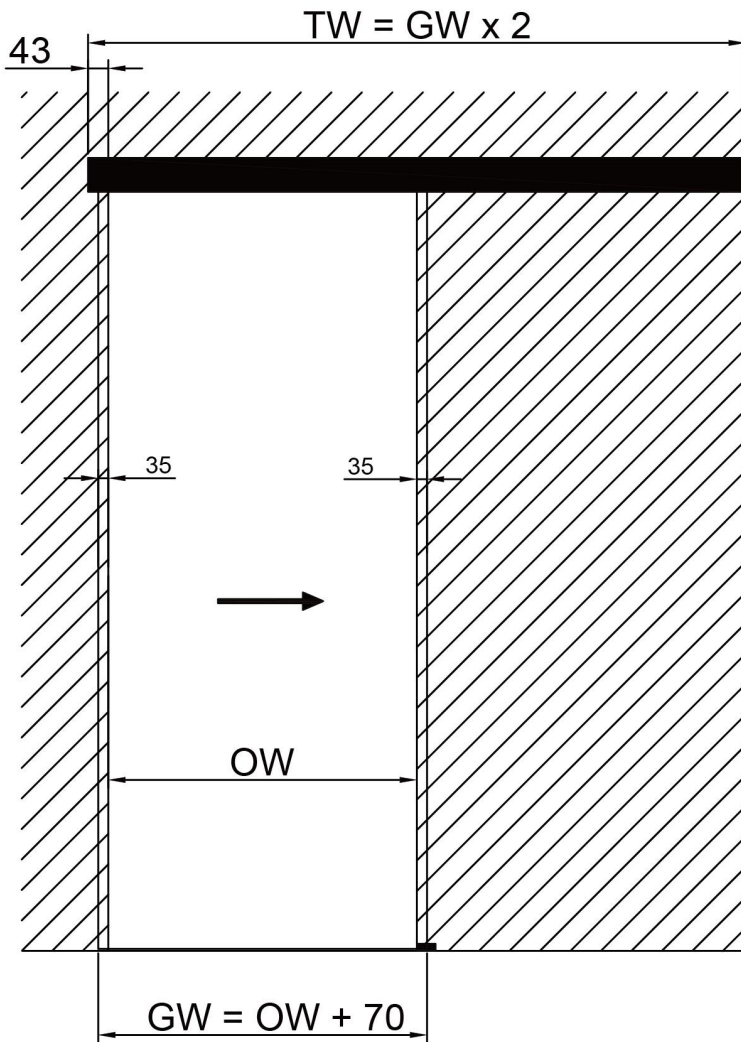

- TH : Total height TW : Total width
- LH : Clear height
- GH : Glass panel height
- OW : Opening width
- GW : Glass panel width
- (min. 740mm for both ends soft stop function)
- T : Glass thickness 10mm (8mm glass clamp by order)
- B : Bottom gap (10mm)
- D : Wall to glass distance
- F : Fixed panel width (see next page)

T	D
8mm	26.5mm
10mm	25.5mm

Recommended tool



HW-001
3 way hex wrench

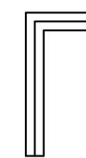

3mm

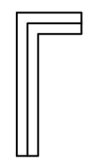

2.5mm

