

# HGT100

## HYDRAULIC PATCH FITTING



### Product Features :

- Fixed power size 3 EN compliance.
- Adjustable closing & latching speed.
- Maximum door opening angle at 180°
- Maximum door control opening angle at 110°
- Mechanical hold-open at 90°
- Non hold open is available by order.

### Finishes:

- PSS : Polished stainless steel.
- SSS : Satin hairline stainless steel.
- Pastic cover in different color/finish by order.

Power size	3
Max. Door width (mm)	1000
Max. Door Weight ( kg)	100
Available glass thickness (mm)	10~13.5

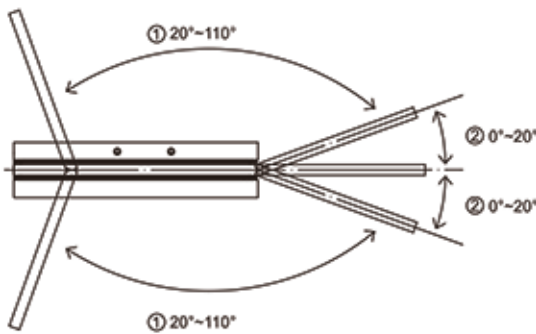

### Dimensions

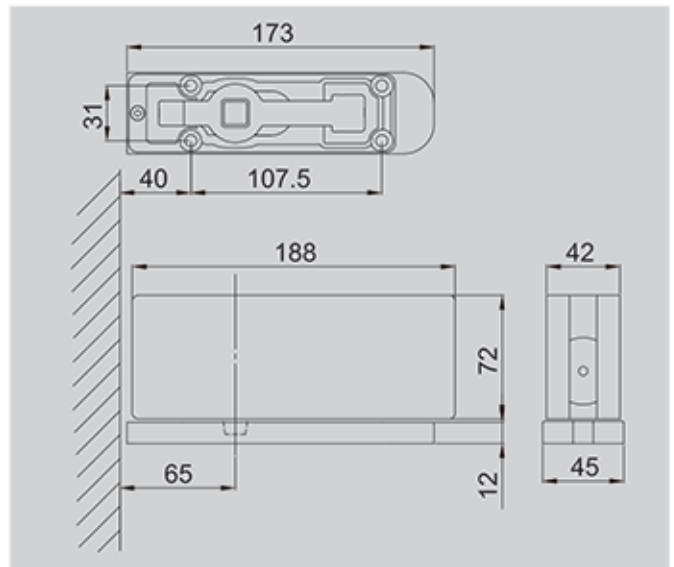

### Glass Cutout

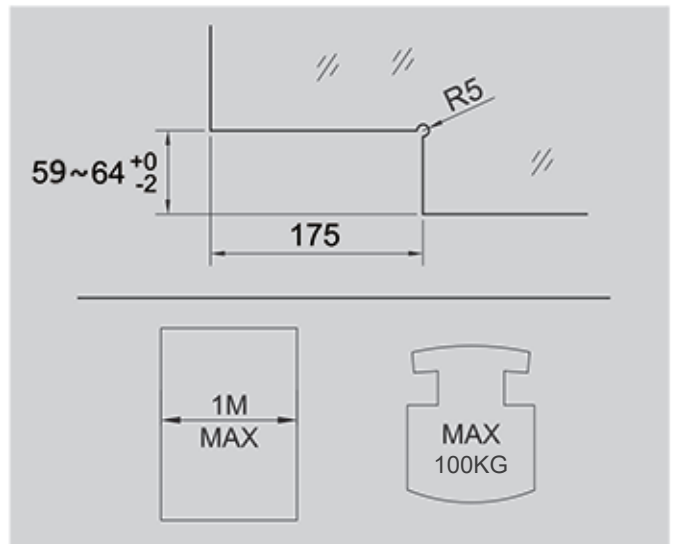

### Application Ranges:

- Suitable for single & double action door.
- Available for light & medium duty door.
- Adjustable Closing & Latching Speed.
- Two non-critical control valves provide dual speed hydraulic closing.

# HGT100 HYDRAULIC PATCH FITTING

## INSTALLATION & ADJUSTMENT INSTRUCTIONS



Unit:mm

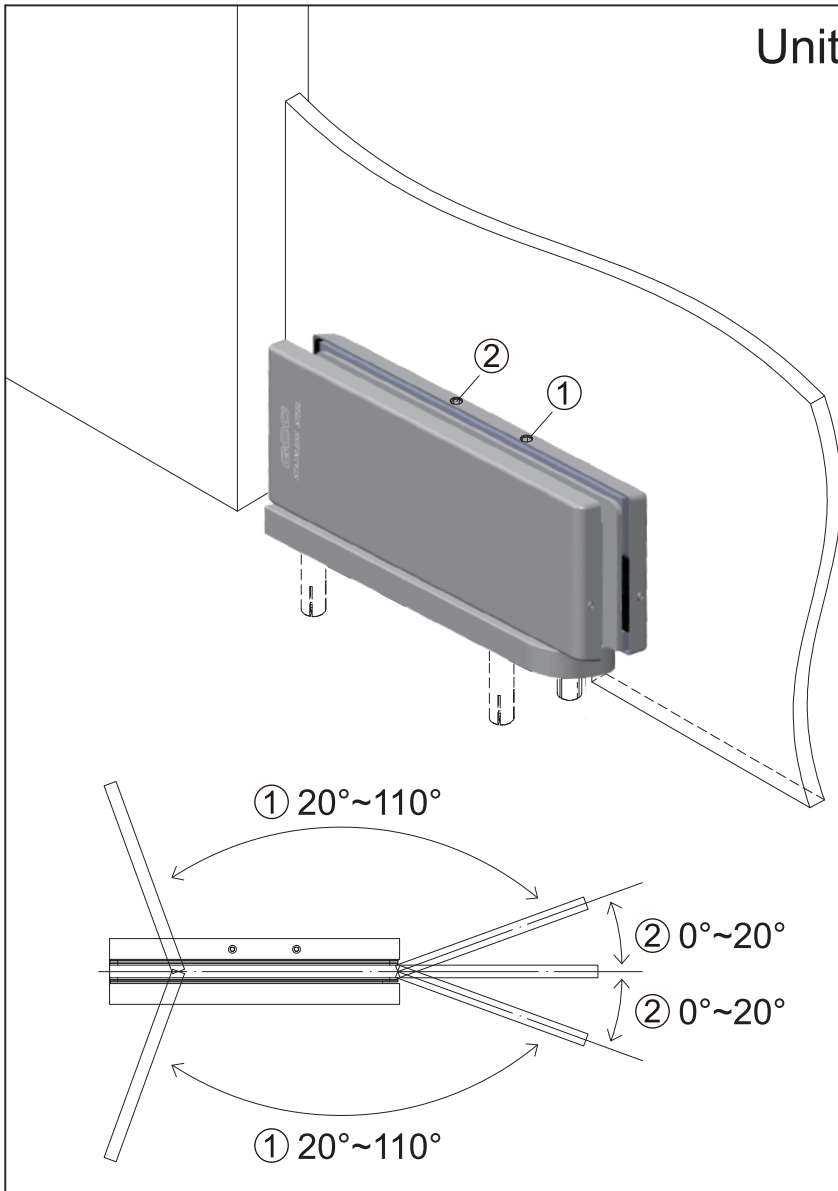

A*		B*		C*					
D*		E*		F*					
G*		H*		I*					
4PCS		4PCS		4PCS		1PC		1PC	
7PCS		1PC		1PC		1PC		1PC	

H\*  
2.5mm-1PC  
1.0mm-4PCS  
0.5mm-2PCS

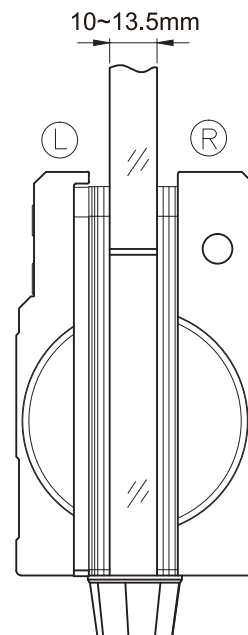
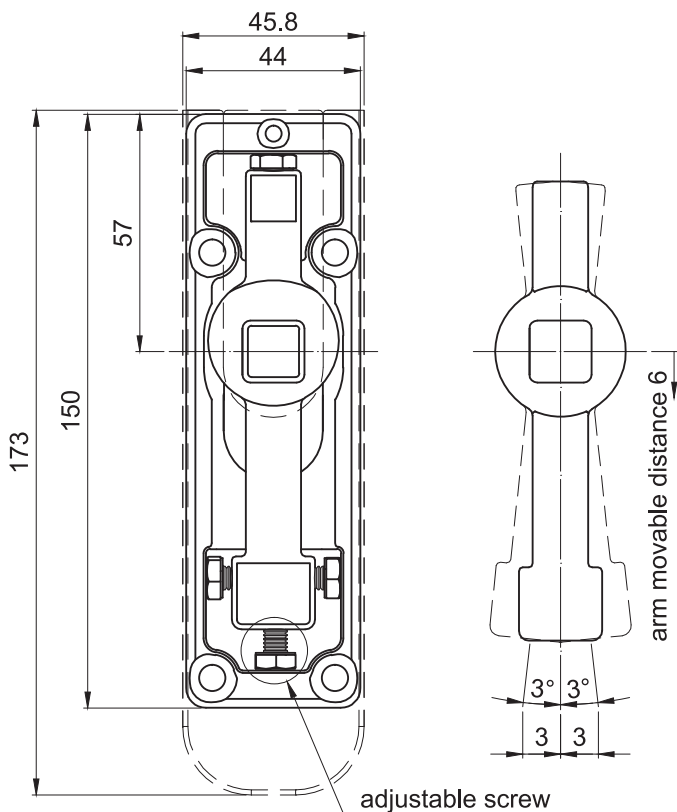

T	0.5mm		1mm		2.5t
	L	R	L	R	L
10	1	1	1	1	1
12	1	1	0	0	1
13.5	1	0	1	0	1



### GOOD CREDIT CORPORATION

No.13, Longmen Rd., Situn Dist.,  
Taichung 40757, Taiwan

E-mail: gctw@ms7.hinet.net

TEL: 886-4-22583755

FAX: 886-4-22583753